

Welcome to The Baltimore Museum of Art

3RD FLOOR

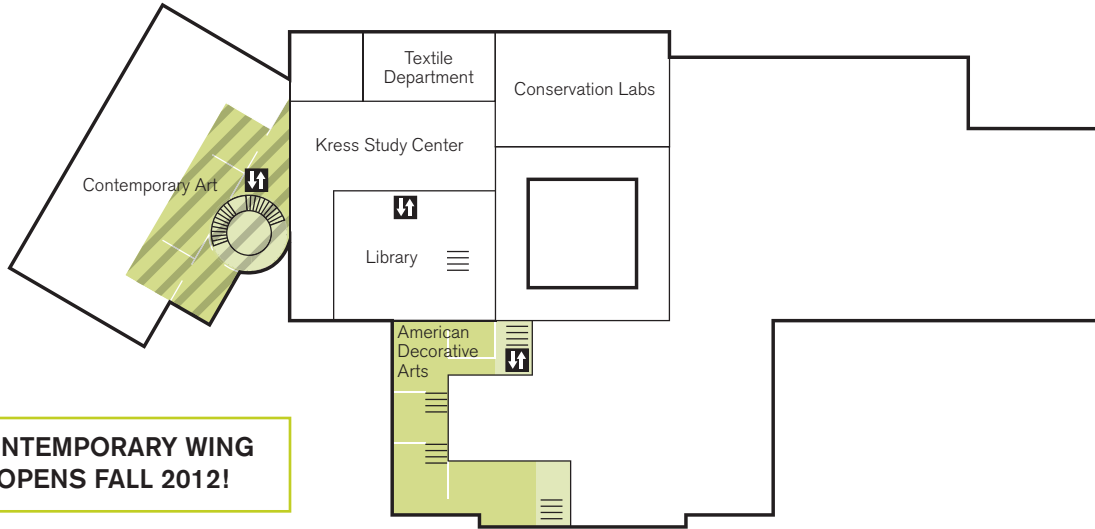

2ND FLOOR



1ST FLOOR

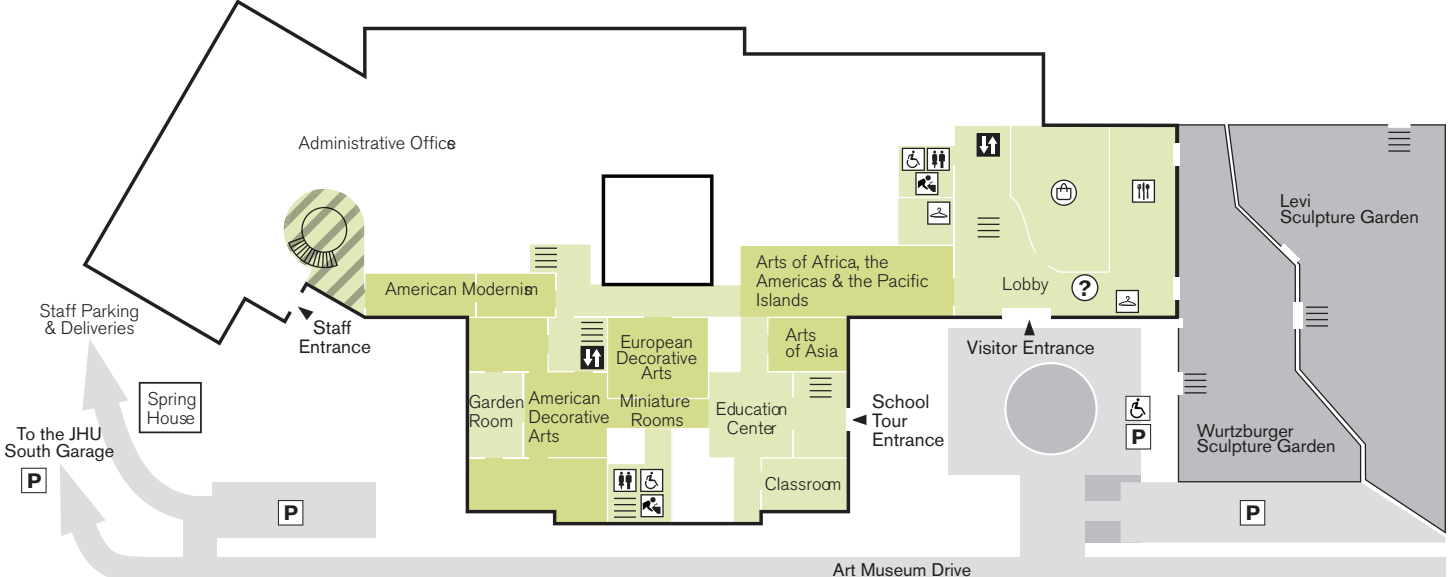

KEY

- Wheelchair Accessible
- Elevator
- Stairs
- Restrooms
- Coat Check
- Drinking Fountain
- Collection Galleries
- Special Exhibition Galleries
- Sculpture Gardens
- Public Area
- Closed for Renovation
- Gertrude's Restaurant
- BMA Shop
- Welcome Desk & Box Office
- Parking

FREE ADMISSION

Free general admission to the Museum—for everyone, every day! Some exhibitions and special events may be ticketed.

FREE AUDIO TOURS

60 Objects | Countless Stories—Explore the BMA's world-class collection through the voices of local writers, curators, and conservators.

Artful Stories: A BMA Family Tour—Tour the collection with Raoudi, Matisse's perky schnauzer.

Sculpture Garden Cell Phone Tour—Discover contemporary and modern works outdoors. Call 443-573-1822. No cost except your minutes.

**FREE GUIDED TOURS
MEET IN THE LOBBY**

Exhibition & Collection Tours (45 mins)
Wednesdays at 2 p.m.

Third Thursday Curatorial Tours (45 mins)
Third Thursday of each month at 1 p.m.

Treasures at the BMA (45 mins)
Saturdays at 11:30 a.m. & 2 p.m.

Sunday Shorts (30 mins)
Sundays at 2:30 p.m.

FREE FAMILY PROGRAMS

Free Family Sundays—Join us for drop-in activities the entire family can enjoy. Sundays, 2–5 p.m. in the Classroom.

Family FunStop—Families can play and learn together with free costume packs and audio tours. Saturdays & Sundays, 12–5 p.m. in the Education Center.

**MUSEUM HOURS
OPEN WED–SUN**

Wednesday–Friday	10 a.m.–5 p.m.
Saturday–Sunday	11 a.m.–6 p.m.

The Wurtzburger and Levi Sculpture Gardens close at dusk and during inclement weather.

The BMA is closed New Year's Day, July 4, Thanksgiving, and Christmas.

**THE BMA SHOP
SHOPARTBMA.ORG
OPEN TUES–SUN**

Tuesday & Saturday	11 a.m.–8 p.m.
Wednesday	10 a.m.–5 p.m.
Thursday & Friday	10 a.m.–8 p.m.
Sunday	11 a.m.–6 p.m.

**GERTRUDE'S RESTAURANT
OPEN TUES–SUN**

Reservations are highly recommended. Call 410-889-3399.

Tuesday–Friday	11:30 a.m.–9 p.m.
Saturday Brunch	10:30 a.m.–3 p.m.
Dinner	5–9 p.m.
Sunday Brunch	10:30 a.m.–3 p.m.
Dinner	5–8 p.m.

BECOME A BMA MEMBER! Enjoy invitations to Members events, 10% savings at The BMA Shop & Gertrude's, FREE or discounted admission to innovative BMA programs, and more! | MEMBERS HOTLINE 443-573-1800 | JOIN TODAY in the Lobby or at The BMA Shop!

VISITOR TIPS

Whether you are a first-time visitor or a lifelong BMA Member, we ask for your help in maintaining a safe environment for visitors and works of art. **Thank you!**

Please...

Help us preserve the art for future generations. **Please do not touch** the works of art. Oils and moisture from hands can cause damage, even to sculptures that are outside.

Lockers are provided free of charge to store over-size items. Please place all packages, umbrellas, backpacks (including baby backpack carriers), and bags or items larger than 11 x 15 inches at the **free Coat Check** in the Lobby.

Keep **food and drinks** out of the galleries and Auditorium.

Use **cell phones** only in Lobby areas, and in the Sculpture Gardens.

The Museum and Sculpture Gardens are smoke-free environments. **Thank you for not smoking.**

Photography & Videotaping—Photography for personal use is welcome in collection galleries and Sculpture Gardens during public hours—without flash, lights, or a tripod—provided it does not endanger works of art or interfere with the viewing experience of others. Photographs may not be reproduced, distributed, or sold without permission from the BMA. Art in temporary exhibitions and on loan may not be photographed. Videotaping is not permitted in the galleries.

Sketching is welcome in the galleries with pencil only. Copyists working with wet media must obtain advanced permission by calling 443-573-1730.

Strollers and Baby Changing—Strollers are welcome but may be restricted during peak times. (Baby backpack carriers and diaper bags must be checked at our free Coat Check.) A baby changing station is available in the Lobby restroom.

Sculpture Gardens are outdoor gallery spaces. Please stay on paved paths and refrain from touching works of art and plantings. For your safety and the safety of others, pets, bicycles, scooters, skates, skateboards, glass containers, and alcoholic beverages are not permitted in the gardens.

ACCESSIBILITY

Wheelchairs—A limited number of wheelchairs are available for use free of charge. Please check in at our Welcome Desk in the Lobby upon arrival.

Wheelchair Accessibility—The Museum and tiered sculpture gardens are wheelchair accessible. Wheelchair accessible restrooms are located on the 1st Floor.

Service Animals—Service animals are welcome in the Museum. Please check in at our Welcome Desk in the Lobby upon arrival.

Assisted Listening Devices—A limited number of assisted listening devices are available for use free of charge for programs in the BMA's Meyerhoff Auditorium.

Special Needs—Tours for visitors who are blind or have low vision, sign language interpreted tours, and selected foreign language tours are available upon request with a minimum of 2 weeks' notice. Please call 443-573-1825 for details.

TTY/HCO 1-800-735-2964